

VMC 4020

SPECIFICATIONS

General	Imperial	Metric
FLOOR TO TABLE SURFACE	32"	812.8 mm
MACHINE WEIGHT	11,000 lbs.	4,990 kg
CONSTRUCTION	Cast Iron on Box Way X/Y/Z	
Table		
TABLE SIZE	48" x 20"	1,219.2 mm x 508 mm
T-SLOTS (NO. x WIDTH x SPAN)	5 x .709" x 3.740"	5 x 18 mm x 95 mm
CUTTING FEED RATE (X/Y/Z)	600 ipm max	15.24 mpm max
RAPID TRAVEL RATE (X/Y)	900 ipm	22.86 mpm
RAPID TRAVEL RATE (Z)	700 ipm	17.78 mpm
MAX. WEIGHT ON TABLE	3,641 lbs. ^c	1,651 kg ^c
BALL SCREW SIZE	1.58" Dia.	40 mm Dia.
LONGITUDINAL (X AXIS)	40"	1,016 mm
LATITUDINAL (Y AXIS)	20"	508 mm
VERTICAL (Z AXIS)	20" (Opt. 28")	508 mm (Opt. 711.2 mm)
SPINDLE NOSE TO TABLE	4"-24" (4"-32" Opt.)	101.6 mm - 609.6 mm (101.6 mm - 812.8 Opt.)
SPINDLE CENTER TO COLUMNWAYS	20.11"	510.794 mm
Accuracy		
AXIS POSITIONING**	+/- .0002"	+/- .0050 mm
AXIS REPEATABILITY**	+/- .0001"	+/- .0025 mm
Spindle		
POWER TRANSFER	Automatic Mechanical, 2 speed VECTOR Drive	
SPINDLE SPEED	10-10,000 RPM	
SPINDLE ORIENTATION	Electromechanical	
SPINDLE TAPER	No. 40	
Tools		
ATC, NUMBER OF TOOLS	21	
ATC, TOOL SELECTION	Random / Bi-directional	
MAX. TOOL DIAMETER (WITHOUT ADJACENT TOOLS)	3"	76.2 mm
MAX. TOOL LENGTH	4.5"	114.3 mm
MAX. TOOL WEIGHT	15 lbs.	6.8 kg
Motor		
SPINDLE DRIVE MOTOR	AC VECTOR Drive	
HORSEPOWER	10 HP / 15 HP *	7.5 kW / 11.2 kW*
TORQUE	60 ft.-lbs. / 160 ft.-lbs. *	81 N-m / 217 N-m*
OPT. HIGH TORQUE SPINDLE	22.5 HP* & 220 ft.-lbs.*	16.8 kW* / 298 N-m*
OPT. VERY HIGH TORQUE SPINDLE	30 HP* & 270 ft.-lbs.*	22.4 kW* / 366 N-m*
AXIS DRIVE MOTOR (X/Y/Z)	AC, 3,800 lb. s.* thru st	AC, 1,724 kg* thrust
Miscellaneous		
AIR PRESSURE REQUIREMENT	80-120 PSI, 15 SCFM (Momentary)	5.5-8.3 Bar, .42m ³ /min (Momentary)
POWER REQUIREMENT (3-Phase)	42 A @ 230 V AC	
SINGLE PHASE (Optional)	60 A @ 220 VAC	
COOLANT POWER	Spindle, X,Y,Z Ball screws	

Options

- 28" Z Travel & Column (Standard 20")
- 30-Position ATC (CAT or BT)
- 24-Position DA TC (CAT or BT)
- Spindle Options
 - 10,000 RPM High Torque
 - 10,000 RPM Very High Torque (240V)
 - 10,000 RPM Air/Oil Spindle
 - 15,000 RPM Air/Oil Spindle
- Coolant thru Spindle (250 psi)
- Rigid Tapping
- Chip Conveyor System
- Flat Sheet Metal Cover
- Ship Machine Un-Caulked
- Auto Aim Servo Coolant
- Single Phase Transformer (ATC Only)
- 480 Volt - 3 Phase Transformer
- Additional Work Light
- Remote Manual Pulse Generator
- 32MP Control
 - Ability to Network
 - High Capacity Hard Drive
 - Shop Floor Programming
- Expanded Memory Levels
 - 422K RAM Memory
 - 4 MB RAM Memory
 - 8 MB RAM Memory
 - 16 MB RAM Memory
- 3.5" Floppy Disk Drive
- Heidenhain Glass Scales
- Renishaw Touch Probes
 - TS-27R Tool Setter Probe
 - MP-11 Probe System
 - MP-12 Probe System
- Rotary Products
 - VH-5C
 - VH-165 mm
 - VH-175 mm
 - VH-225 mm
 - VH-275 mm
 - TR-165 mm (5-Axis)
 - V-300 mm
 - V-400 mm
 - Rotary Accessories
- Midaco Pallet Changer
- Tooling Packages
 - (11) Tool Starter Package
 - (20) Tool Premium Package
 - Tooling Certificates

VMC 4020 TABLE DIMENSIONS

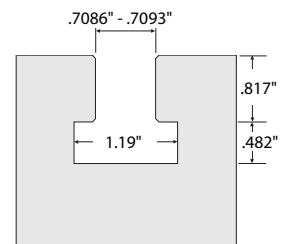
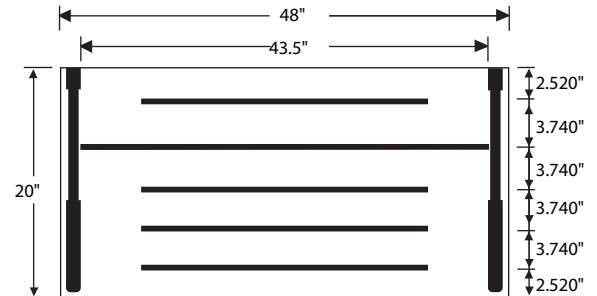

T-SLOT

^c Evenly Distributed Weight

* Peak

** All accuracies are quoted at 68°F.

Fadal reserves the right to change standard and optional machine accessories.

Extended column add 8" to height

Continuous equivalent A-weighted sound pressure at workstation is 77 db(A) or less during normal cutting operations.

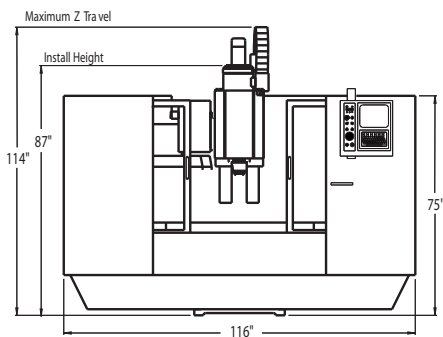

Front View

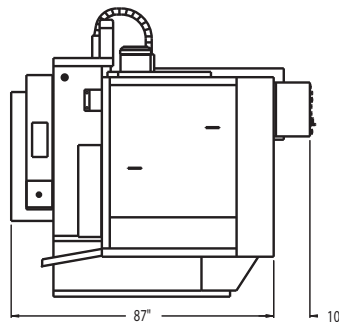

Side View